



Steel Multi Grip Lockbolts Button / Truss Head

Two piece swage lock fastening system consisting of a pin and collar. A versatile fastener due to its wide grip range, high speed assembly and uniform installed values. Excellent clamping force and vibration resistance. Available in steel and aluminium.

Material: Carbon Steel

Finish: Zinc Plated

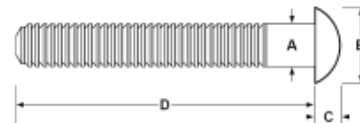

Diameter	Part Code	Grip Range	Hole Size	A	B	C	D	Clamp	Shear KN	Tensile KN
MGPB I Steel Lockbolt I Button Head										
4.80	SPBR-0610	1.6-15.9	5.20	4.80	10.00	3.20	46.00	4.10	7.70	7.30
	SPBR-0620	7.9-31.8	5.20	4.80	10.00	3.20	52.00	4.10	7.70	7.30
6.40	SPBR-0810	1.6-15.9	6.70	6.40	13.20	3.90	50.00	5.30	9.80	13.30
	SPBR-0820	7.9-31.8	6.70	6.40	13.20	3.90	65.00	5.30	9.80	13.30

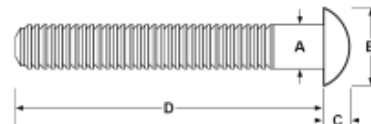

MGPT I Steel Lockbolt I Truss Head										
4.80	SPTR-0610	1.60-15.9	5.20	4.80	12.40	2.70	46.00	4.10	7.70	7.30
	SPTR-0620	7.90-31.8	5.20	4.80	12.40	2.70	61.00	4.10	7.70	7.30
6.40	SPTR-0810	1.60-15.9	6.70	6.40	15.10	3.00	50.00	5.30	9.80	13.30
	SPTR-0820	7.90-31.8	6.70	6.40	15.10	3.00	66.00	5.30	9.80	13.30

Collar	Collar type	Part Code	A mm	B mm	C mm
4.80	Standard	SPCR-0600	7.90	7.00	9.50
4.80	Wide Flange	SPCR-06WF	7.90	8.50	17.00
6.40	Standard	SPCR-0800	10.20	9.50	13.00
6.40	Wide Flange	SPCR-08WF	10.20	11.00	22.00

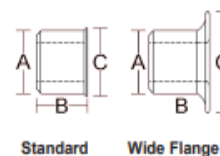

Dimensions and specifications are subject to change without notice. Check your distributor for the latest data sheet. The test data provides approximate strength values averaged in multiple tests in various materials and thicknesses.