



Steel Multi Grip Lockbolts Countersunk / Broad head

Two piece swage lock fastening system consisting of a pin and collar. A versatile fastener due to its wide grip range, high speed assembly and uniform installed values. Excellent clamping force and vibration resistance. Available in steel and aluminium.

Material: Carbon Steel

Finish: Zinc Plated

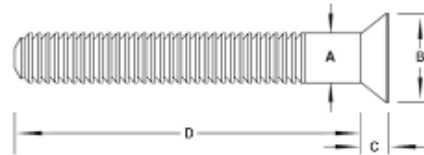

| Diameter | Part Code | Grip Range | Hole Size | A | B | C | D | Clamp | Shear KN | Tensile KN |
|--|------------|------------|-----------|------|-------|------|-------|-------|----------|------------|
| MGP90 - Steel Lockbolt - 90° Countersunk Head | | | | | | | | | | |
| 4.80 | SP90R-0610 | 2.7-15.9 | 5.20 | 4.80 | 10.00 | 2.60 | 46.00 | 4.10 | 7.70 | 6.20 |
| 6.40 | SP90R-0810 | 3.3-15.9 | 6.70 | 6.40 | 13.20 | 3.30 | 50.00 | 5.30 | 9.80 | 11.30 |
| | SP90R-0820 | 7.9-31.8 | 6.70 | 6.40 | 13.20 | 2.90 | 66.00 | 5.30 | 9.80 | 11.30 |

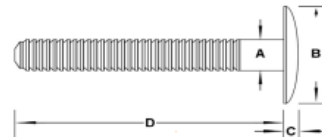

| MGP30 - Steel Lockbolt - Broad Truss Head | | | | | | | | | | |
|--|--------------|-----------|------|------|-------|------|-------|------|------|-------|
| 6.40 | MGP30-R8-10G | 1.60-16.0 | 6.70 | 6.40 | 25.00 | 4.10 | 50.80 | 5.30 | 9.80 | 11.30 |
| | MGP30-R8-24G | 16.0-38.0 | 6.70 | 6.40 | 25.00 | 4.10 | 72.00 | 5.30 | 9.80 | 11.30 |

| Collar | Collar type | Part Code | A mm | B mm | C mm |
|--------|-------------|-----------|-------|-------|-------|
| 4.80 | Standard | MGC-R6U | 7.90 | 7.00 | 9.50 |
| 4.80 | Wide Flange | MGCW-R6U | 7.90 | 8.50 | 17.00 |
| 6.40 | Standard | MGC-R8U | 10.20 | 9.50 | 13.00 |
| 6.40 | Wide Flange | MGCW-R8U | 10.20 | 11.00 | 22.00 |

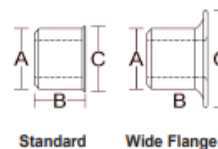

Dimensions and specifications are subject to change without notice. Check your distributor for the latest data sheet. The test data provides approximate strength values averaged in multiple tests in various materials and thicknesses.